

ANTIQUITIES & MONUMENTS ORDINANCE (CAP. 53)

PLAN OF FLIGHT OF STONE STEPS AND GAS LAMPS IN DUDELL ST., HONG KONG ISLAND

DEPOSITED IN THE LAND OFFICE, VICTORIA, UNDER SEC. 3 (4)

SERIAL No. HKM 10

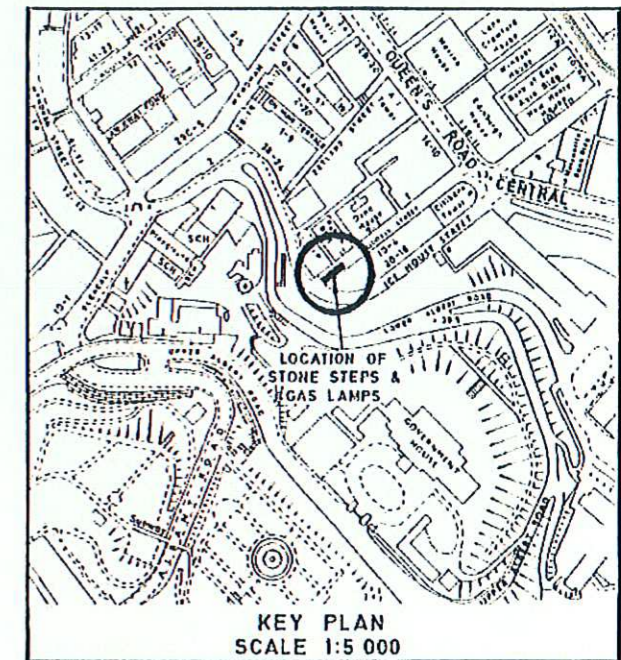
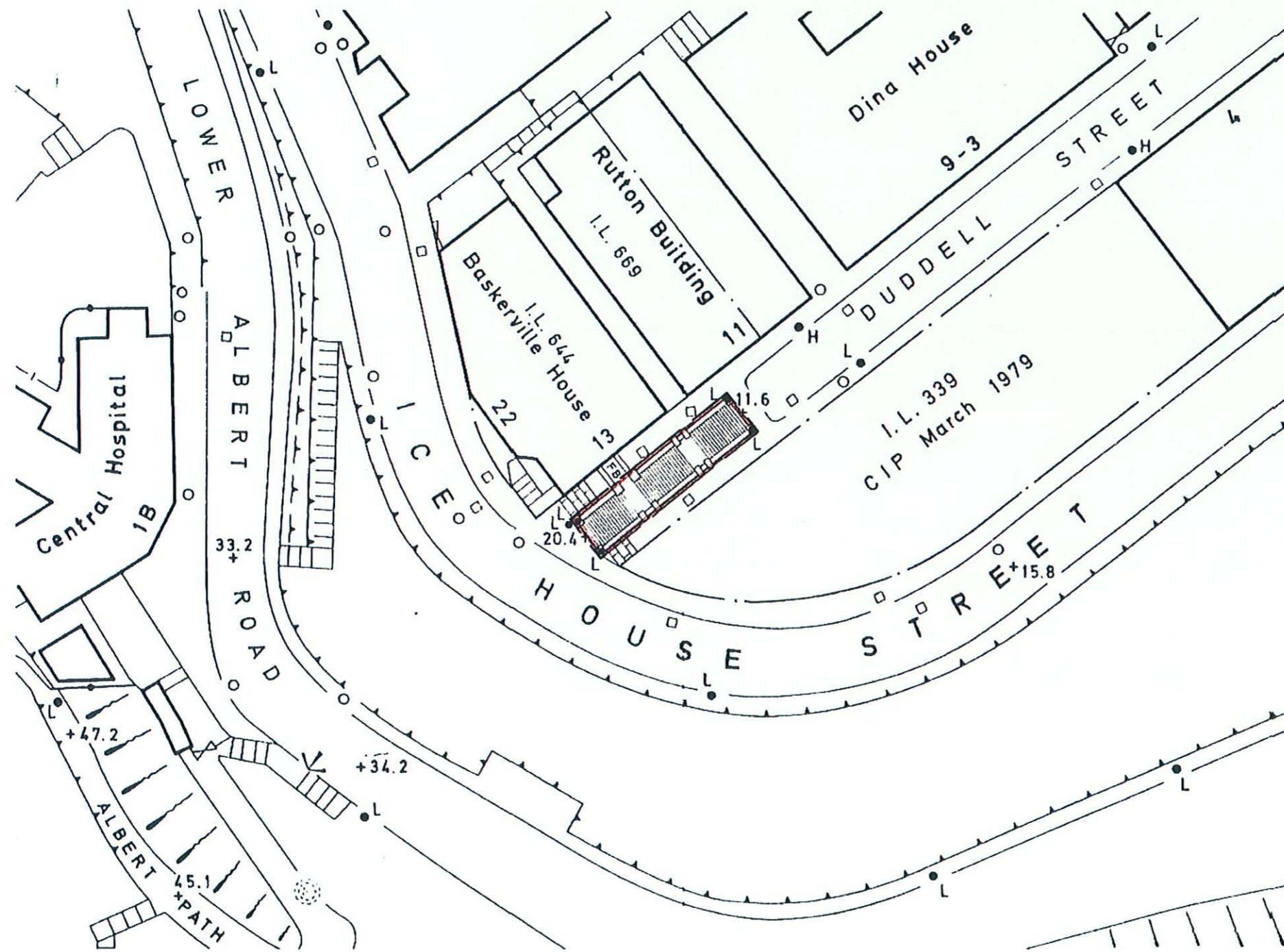

KEY PLAN
SCALE 1:5 000

EDGED RED AREA 100 m² (ABOUT)

(Heights in metres)

SCALE 1:500

Crown Lands & Survey Office, Hong Kong.

cc Wade
SECRETARY FOR HOME AFFAIRS & INFORMATION
DATE 15/8/79